

**120 x 120 x 38 mm**

- Motor Design : Shaded Pole
- Housing : Aluminium Die-cast (Painted Black)
- Impellor : Thermoplastic PBT (UL 94V-0)
- Bearing : Sleeve or Ball
- Operating Voltage : 185 - 245 VAC
- Dielectric Strength : AC 1500V for 1 minute
- Insulation : Class B
- Insulation Resistance : Above 100M Ohms at 500 VDC
- Connection : T = Terminal
- Motor Protection : Impedance Protected
- Operating Temperature : - 10 to +70°C for Sleeve Bearing  
- 20 to +70°C for Ball Bearing
- Net Weight : 510 Grams



**Specification**

Model	Bearing	Voltage	Frequency	Current	Input Power	Speed	Air Flow	Static Pressure	Noise
REC		V	Hz	A	W	RPM	CFM	mm H <sub>2</sub> O	dB(A)
22038 A1 M T	Sleeve	115	50/60	0.23/0.19	16 /15	2650 /2900	85 /110	6.4/7.6	43/48
22038 B1 M T	Ball	115	50/60	0.23/0.19	16 /15	2700 /3000	90 /115	6.8/8.0	43/48
22038 A2 M T	Sleeve	230	50/60	0.13/0.11	22 /18	2650 /2900	85 /110	6.4/7.6	43/48
22038 B2 M T	Ball	230	50/60	0.13/0.11	22 /18	2700 /3000	90 /115	6.8/8.0	43/48
22038 A24 M T	Sleeve	24	50/60	1.10/0.90	17 /15	2650 /2900	85 /110	6.4/7.6	43/48

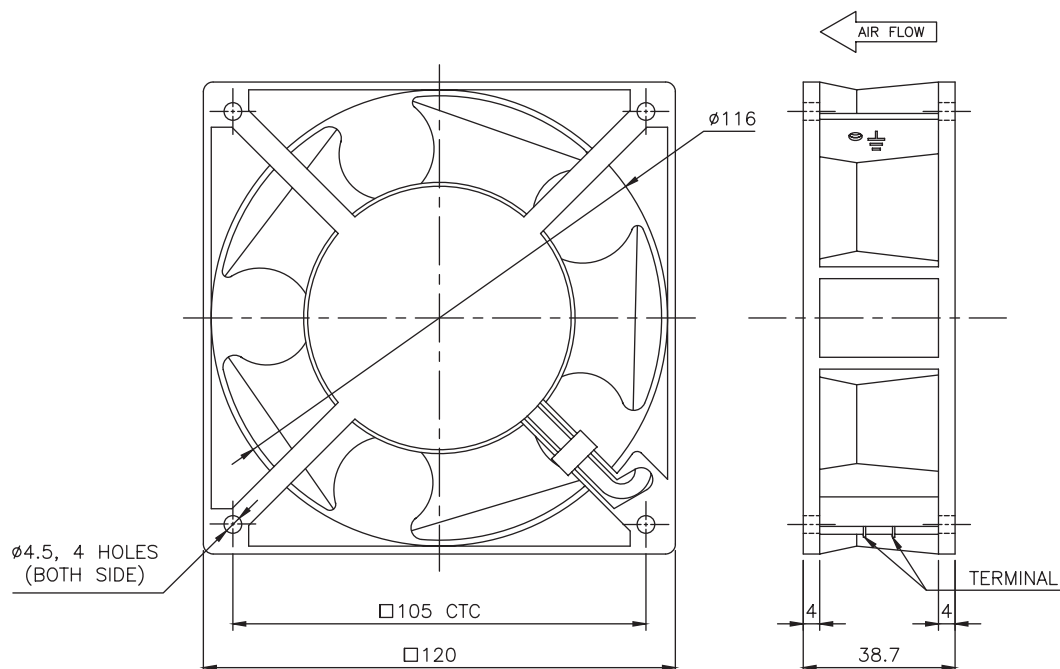

\* Specifications Subject to Change Without Notice